

Access aids

Holding bar with double handle

- + Made of stainless steel (AISI 316 Ti), pickled and passivated
- + High economic efficiency due to its mobile application as only the sleeve is permanently left in the shaft

Length in m	Weight in kg	Article No.
1.60	3.5	816405

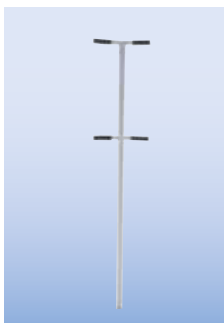

Sleeve

- + Made of stainless steel (AISI 316 Ti), pickled and passivated (round) or steel galvanised (quadrangular)
- + Suitable to be used with access aid, article no. 816405

Product information	Weight in kg	Article No.
Stainless Steel (AISI 316 Ti)	1.1	816412
Steel galvanised	1.1	816429

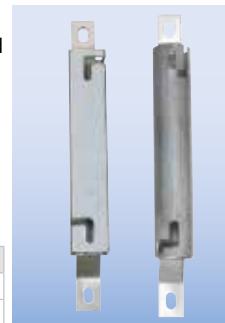

Holding bar with single-sided handle

- + Made of stainless steel (AISI 316 Ti), pickled and passivated or steel galvanised
- + Retractable handle to be attached to the wall
- + Sleeve included

Product information	Length in m	Weight in kg	Article No.
Stainless Steel (AISI 316 Ti)	1.50	4.5	816436
Steel galvanised	1.50	4.5	816443



Grip bar with handle on one side

- + Made of stainless steel (AISI 316 Ti), pickled and passivated or steel galvanised
- + Retractable handle to be attached to the ladder's side rails with the size of 50 x 20 x 60 x 25 mm (not suitable for glass-fibre reinforced plastic shaft ladder)
- + Sleeve included

Product information	Length in m	Weight in kg	Article No.
Stainless Steel (AISI 316 Ti)	1.50	5.0	816450
Steel galvanised	1.50	5.0	816467

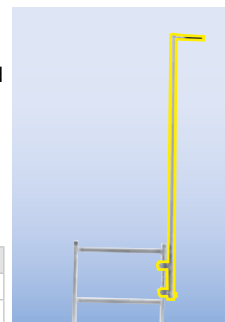

Holding frame

- + Made of stainless steel (AISI 316 Ti), pickled and passivated or steel galvanised
- + Retractable handle, supplied with metal fittings for side rails with a size of 50 x 20 mm and an external width of 340 x 440 mm

Product information	External width in mm	Usable length in m	Article No.
Stainless Steel (AISI 316 Ti)	340	1.10	816474
Steel galvanised	340	1.10	816481

Product information	External width in mm	Usable length in m	Article No.
Stainless Steel (AISI 316 Ti)	440	1.10	816498
Steel galvanised	440	1.10	816504



Accessories

Express anchor

- + We recommend express anchors to mount the sleeves to the shaft wall (building authority approved), minimum thickness of concrete 220 mm

No image

Article No.
816511

Fall protection equipment

Fall protecting rail with connecting link

Product information	Length in m	Article No.
Steel galvanised	1,40	837202
	1,96	837219
	2,80	837226
	3,64	837233
Stainless steel	1,40	837240
	1,96	837257
	2,80	837264
	3,64	837271

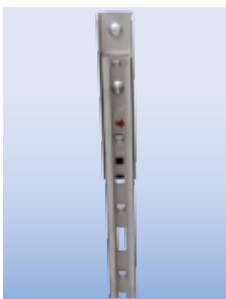

Rail attachment for rungs of ladder

- + To mount fall protection rails to the ladder
- + To be attached in spacings of 1.68 m, for shorter ladders a minimum of four mounting points are required

Product information	Depth of rungs	Article No.
Steel galvanised	25 mm	837301
Stainless steel	25 mm	837325

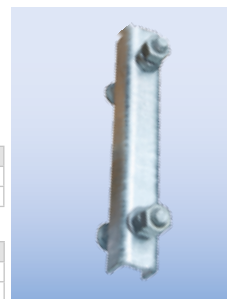

For shaft ladders

Product information	Depth of rungs	Article No.
Steel galvanised	26–35 mm	837318
Stainless steel	26–35 mm	837332

Climbing stop

- + Applicable as stop for the safety runner to avoid unintentional sliding off the rail

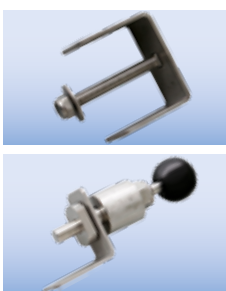

Safety runner

- + With snap hook
- + Smooth-running without sharp edges
- + Ratchet made of stainless steel
- + The ascent and descent is possible without leaning backwards



Product information	Type	Article No.
Stainless steel	Rigid	837387
	Removable	837479

Article No.
837349

Harness

- + In accordance with DIN EN 361 and DIN EN 355
- + Made of tear-proof nylon strap
- + With broadened back part
- + With d-rings in the middle of the front and the back section

Weight	Article No.
1,4 kg	837370



Intermediate platform, retractable

- + After a climbing height of 10 m an intermediate platform has to be installed
- + Will be screwed-on to the fall protecting rail from behind

Product information	Article No.
Steel galvanised	837455
Stainless steel	837462



Exit device

- + To remove the climbing safety runner at the favoured destination
- + A track with a length of 149 m is built-in between the fall protecting rails
- + Rail connectors are included
- + Applicable for intervals between rungs of 270–315 mm with a depth of the rungs of 25–45 mm

Product information	Article No.
Steel galvanised	837431
Stainless steel	837448



Interchange device

- + Steel galvanised
- + Exit aid e.g. on roofs
- + 180° rotatable at exit area
- + Rail reinforcement (article No. 837363) has to be ordered separately
- + The reinforcement of the rails consists of 3 rectangular tubes to stiffen the overhanging interchange device

Length in m	Article No.
1,40	837356
3,00	837363



Shaft access aid

- + Stainless steel
- + Base part with access aid (see small image), article no. 837424, has to be ordered separately

Product information	Article No.
Stainless steel	837417
Product information	Article No.
Stainless steel	837424



KRAUSE's tip: The base part of the access aid is made of stainless steel (AISI 316 Ti). It remains at the shaft ladder and can only be used together with the shaft access aid.